

PIPESTONE RV CAMPGROUND

919 N HIAWATHA AVE , PIPESTONE, MN 56164

[Pipestone County]

Phone: (507) 825-2455

Email: pipestonervcampground@gmail.com

Set GPS to E W96 317370°, N N44 009420°

TYPE: Private. pets welcome.eco-Friendly

DIRECTIONS: good gravel interior rds. good paved access rd. (North of town) From Jct of US-75 & SR-23 (N side of town), N 0.4 mi on US-75 to NE 9th St (CR-22), W 0.6 mi (R); or From Jct of I-90 & SR-23 (exit 1), N 28 mi on SR-23 to Hiawatha Ave, N 1.4 mi (R).

SPOTLIGHT : Friendly service & clean facilities always await you. We welcome children & pets. Enjoy our heated pool, mini golf, game room, playground. Our 3200 sq ft indoor pavilion is available for large group events. We are close to restaurants and shops.

SITES: 60 available: 28 gravel sites, 32 grass sites, no patios, some shade, 31 pull-thrus (35 x 60), big rig sites, Back-ins (30 x 65), some side-by-side hookups, 30 full hookups, 30 water, 30 electric (30/50 amps), Table at site, Trash Pickup at Site, WiFi Available.

FACILITIES: restrooms and showers, dumping station, emergency phone, laundry, RV supplies, firewood, RV storage, library, ice.

SERVICES: escort to site, Fax/Copy service.

RECREATION: Heated pool, horseshoes, enclosed rec hall, enclosed game room, playground, outdoor games, mini golf, nature trails.

OPEN: Open from May 15 to Oct 1.

RATES: \$27 to \$32 (Last year's).
Visa, MasterCard, Discover, Debit Card.

TL RATING: Park: 9, Restrooms: 8.5, Visual: 8.

Pipestone Creek

PIPESTONE RY CAMPGROUND

THE NICEST LITTLE CAMPGROUND
IN THE NICEST LITTLE CITY IN MINNESOTA!

919 N. Hiawatha Ave. • Pipestone, MN 56164

507.825.2455

www.pipestonercampground.com



Nature Walk



Bonfire Pit

Group Site



Horseshoes



Volleyball Court

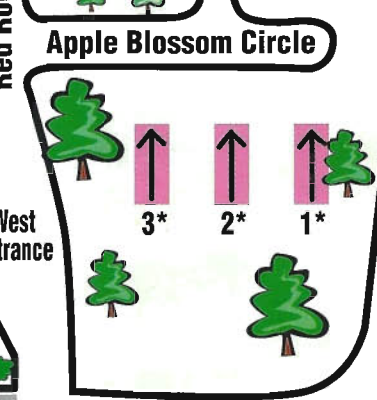
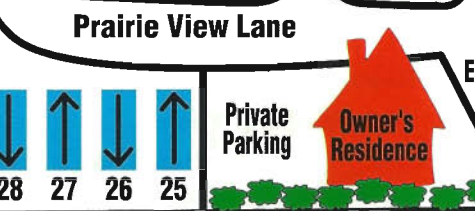
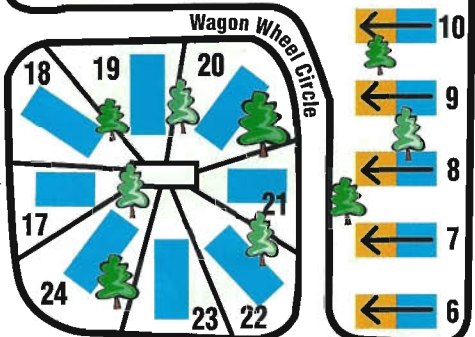
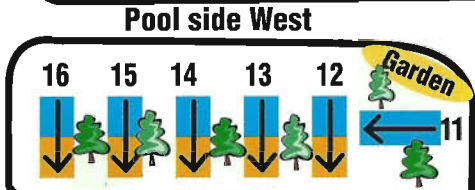
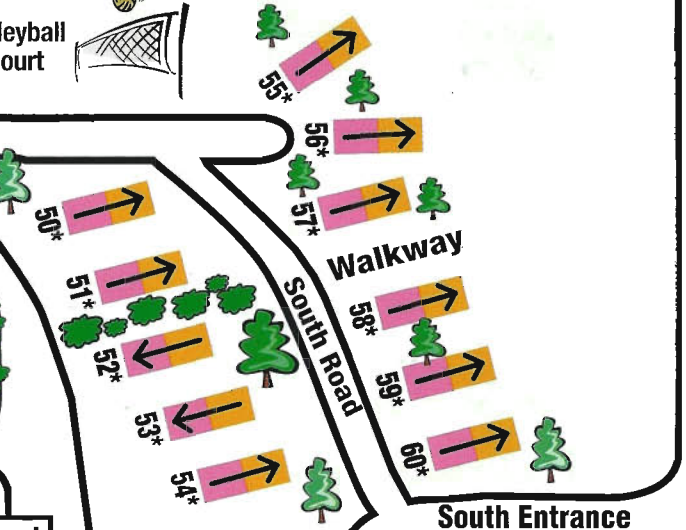
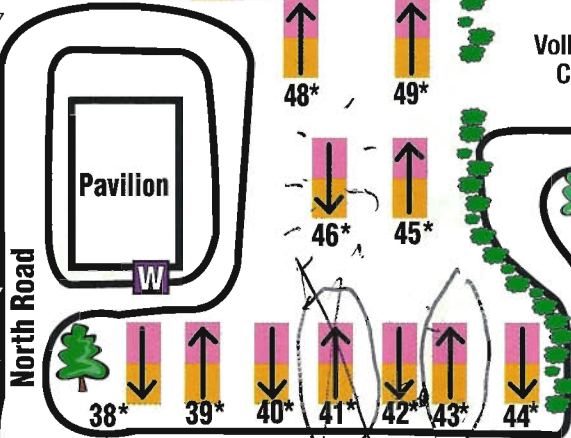

N ←

- Water/Elec./Sewer (Pull thru)
- Water/Elec. (Pull thru)
- Water/Elec. Only
- Water/Elec./Sewer
- Rustic Tents Only
- Rustic Camping Tipi
- Cable TV Avail.
- Telephone
- Water

Hiawatha Avenue

Pet Walk, Paved

9th Street NE

PIPESTONE COUNTY CAMPGROUND

THE NICEST LITTLE CAMPGROUND
IN THE NICEST LITTLE CITY IN MINNESOTA!

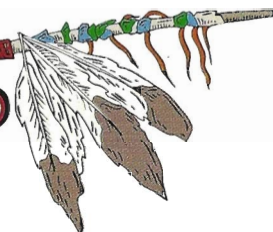

CAMPGROUND STANDARDS

The most important standard is:

Do unto others as you would have them do unto you.

***CHECKOUT TIME IS 11 a.m.** Extended checkout may be available and **MUST** be arranged in office prior to 10 a.m. Additional charges may apply. **SUNDAYS AND HOLIDAYS CHECKOUT IS 1 P.M.**

***CHECK-IN TIME IS after 3 PM** Except Fridays & Saturdays check-in is after 1 pm. Early check-in is offered for a fee when space is available.

***QUIET HOURS** are 10 p.m.- 8 a.m.

***ACTIVITIES**-Check white board outside of office for family ideas

***CAMPFIRES** are **ONLY** allowed in fire rings. Burn only wood. **DO NOT MOVE FIRE RINGS.** FIRE WOOD may be purchased in camp store during office hours. MN Department of Agriculture prohibits campers from bringing wood cut from outside Pipestone County.

***VISITORS**-Our insurance requires that all visitors must check in at the office. There is a **FEE FOR VISITORS** to use campground facilities (pool, bathrooms, playground). Visitors are not allowed to remain in the park without the registered camper present.

***RESTROOMS**-An adult should accompany children under the age of 10 to the restroom. Please report any concerns or problems with facilities to the office.

***PARKING**-Please do not block any roads with a vehicle. Additional parking off your site is available if needed.

***MOTORIZED VEHICLES** (Golf carts, scooters, etc.) may only be operated by licensed drivers on campground property.

NO ATVS ALLOWED.

***VEHICLE WASHING** for one vehicle is \$5, to wash two is \$8. You may wash your front windows as far back as your side mirrors at no charge.

***PETS MUST BE LEASHED TO A PERSON** and not tied up alone. Please pick up after them. Office has free doggie bags.

***SWIMMING POOL** is open at 10 a.m.-8 p.m. **CHILDREN UNDER 12 MUST BE WITH AN ADULT.** Only registered campers and their registered visitors are allowed to use pool. Everyone must vacate pool area during a thunderstorm. Only toys made for pool use are allowed. **SWIM AT YOUR OWN RISK. NO LIFEGUARD.**

***TRASH**-We will be happy to pick up your trash at your site if you place it in a secure bag along side the road. Trash pickup is between 7 a.m.-11 a.m. Do not put your trash out at night as animals may get into it. A dumpster is located along the road south of the game room. Recycling containers are located next to dumpster.

SORRY! NO REFUNDS

***THANK YOU** for helping us keep your campground a nice place for your family vacations. Anyone who disregards these standards or is a disturbance to other campers will be asked to leave. If there is anything we can do to make your stay with us more enjoyable, please tell the office or a campground host.

2011/2012 RATES

Daily

Sewer/Water/Elec..... \$32.00

Water/Elec. \$27.00

add \$2 for cable TV sites

Rustic Tent \$20.00

Tipi (up to 6 persons) \$30.00

ALL RATES BASED ON 2 PERSON OCCUPANCY.

Children under 17 free. **EXTRA ADULT \$3.00 per night.**

****10% DISCOUNT TO GOOD SAM CAMPING CLUB,
AAA AND LARGE GROUPS**

LONG TERM RATES AVAILABLE UPON REQUEST.



Kids and pets are welcome!

Open May 1st thru October 15th

Weekly, Monthly & Seasonal Rates Offered

15 acres, both open & shaded

62 level RV sites

39 sewer sites - all with cable TV

33 large pull-thrus

Big Rigs Welcome

Free Wi-Fi

Dump Station

Clean, Air Conditioned Laundry Facility

Great Location for Club Rallies!



Special Group Rates Available

3200 Square Feet Pavilion with bathrooms & kitchen



Fire Rings on Every Site/Grassy Tent Sites with Grills
Firewood for Sale in Fully Stocked Camp Store
Clean Air Conditioned Bathrooms & Hot Showers



Heated Outdoor Swimming Pool / Game Room
Playground, Basketball, Volleyball, Horseshoes & More
Golf, Tennis & Skateboard Park nearby



2 Camping Tipis for rent
Close to restaurants & shops, / Walk to
historic downtown / Biking & Hiking Trails

*Friendly Service & Clean Facilities Always Await You
at the Pipestone RV Campground*

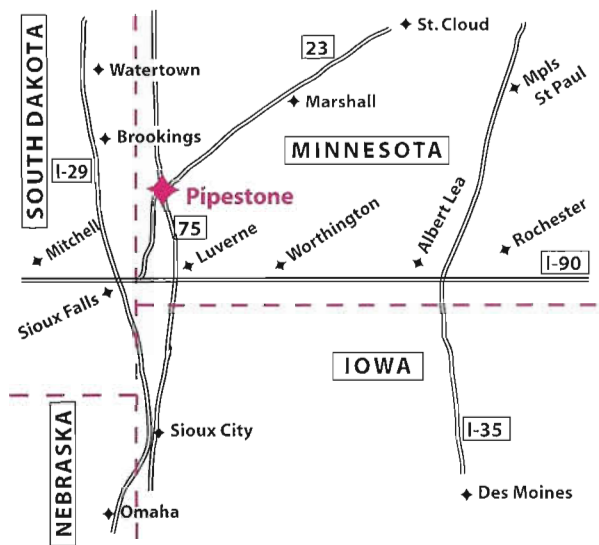

Directions

- ↗ **From the Southwest:**
I-90 to Hwy 23 (Exit #1),
North 30 miles.
- ↖ **From the Southeast**
I-90 to Hwy 75 (Exit #12),
North 24 miles.
- ↓ **From the North:**
Hwy. 23 at Marshall, MN,
Southwest 43 miles.



Campground is located directly across the street (E) from Pipestone National Monument and Hiawatha Pageant Grounds. Less than 2 miles to golf, tennis courts, speedway & fairgrounds.

Pipestone RV Campground LLC
919 North Hiawatha Avenue
Pipestone, MN 56164
[507] 825-2455
www.pipestonervcampground.com

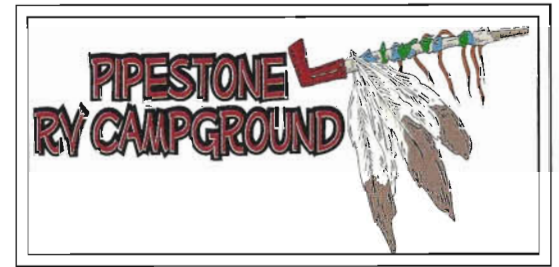

919 North Hiawatha Avenue
Pipestone, MN 56164
[507] 825-2455
www.pipestonervcampground.com

